

Installtion manual of LED Medicine Cabinet

Size:

24"*31-1/2"*5-1/2" (610*800*122mm)
 27"*31-1/2"*5-1/2" (686*800*122mm)
 30"*31-1/2"*5-1/2" (762*800*122mm)
 33"*31-1/2"*5-1/2" (838*800*122mm)
 36"*31-1/2"*5-1/2" (914*800*122mm)
 48"*31-1/2"*5-1/2" (1219*800*122mm)

Please read the installation instructions carefully before installation.

This product should only be installed by qualified professionals.

Before installing this product, you must confirm that the power supply is disconnected

Tools

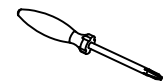
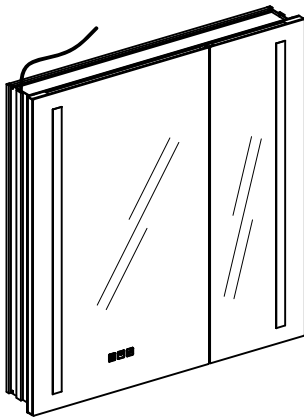

Phillips
Screwdriver



Drill bit
(Φ=5/16")



Power Drill

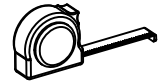

Tape Measure



Metal File

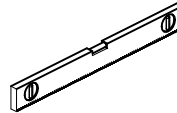

Level

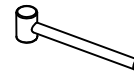

Hammer

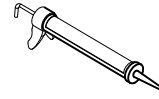

Caulk

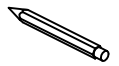

Pencil

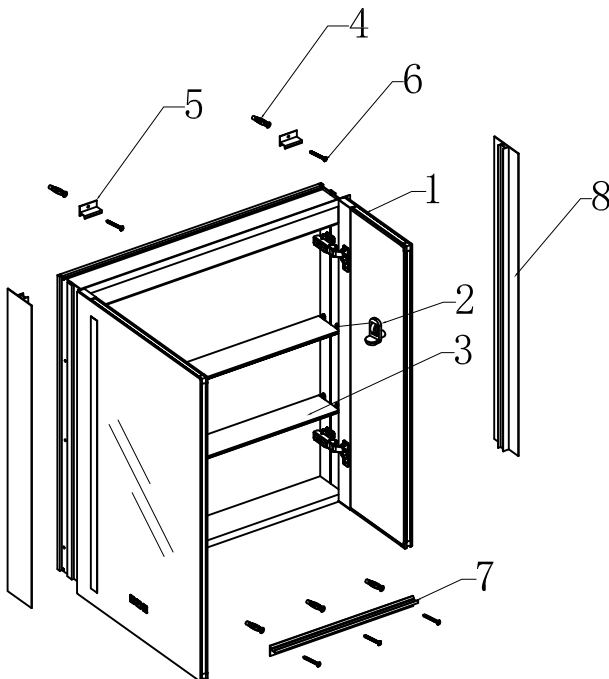

Parts list

#	ITEM	Qty	#	ITEM	Qty
1	LED Medicine Cabinet	1PCS	5	Bottom bracket	2(3)PCS
2	Shelf clip	8(16)PCS	6	#9 x 2 in. Screws	6(8)PCS
3	Shelf glass	2(4)PCS	7	Bottom bracket	1PCS
4	Wall anchors	6(8)PCS	8	arthropleure	2PCS

Power cables position
Input:110V, 50/60Hz

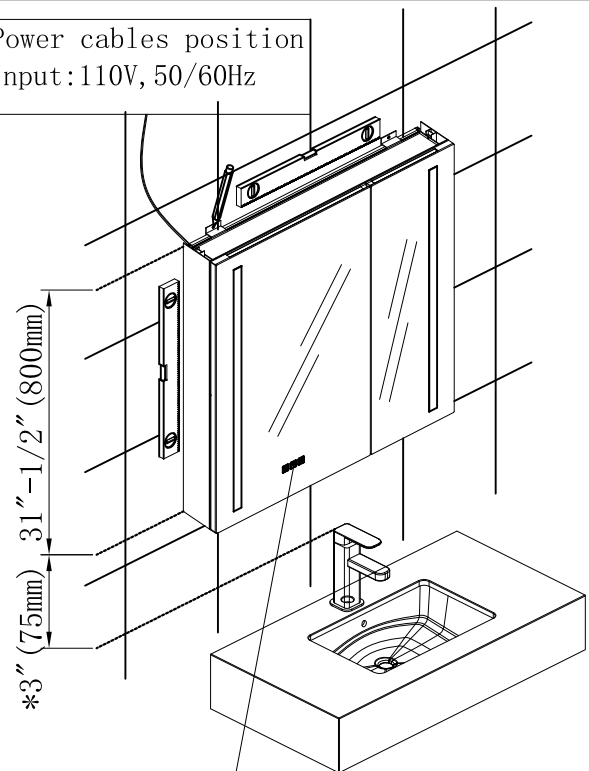

Anti-fog/dimming and light switch/Color

1). Determine the installation position of the LED Medicine Cabinet and mark it with a level on the wall.

NOTE:LED Medicine Cabinet should be placed minimum of 3" above the faucet.

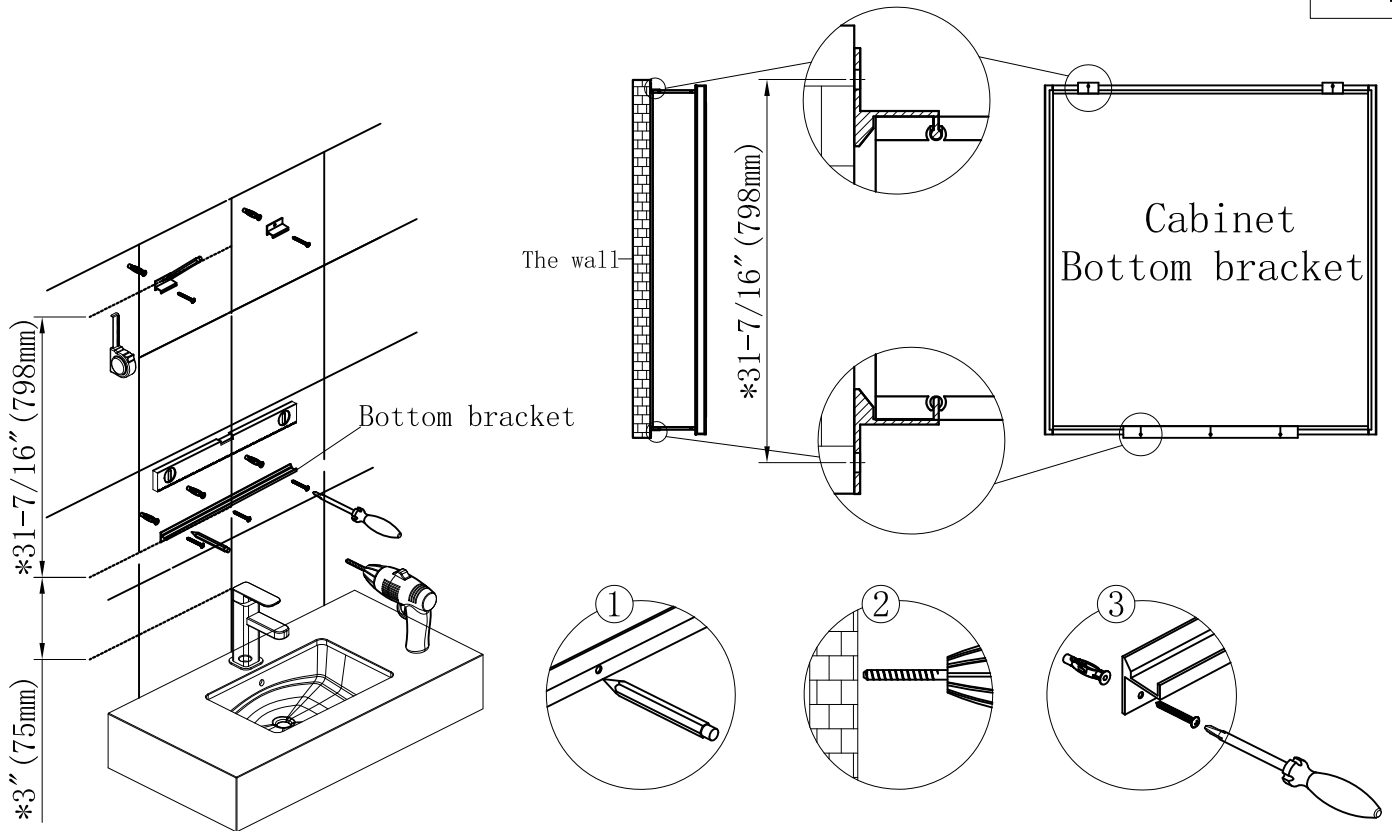

- 2) A. As shown above, mark the position of the Bottom bracket and the drilling position
- B. Install the Bottom bracket and make sure it is solid.
- C. Mount the LED medicine cabinet on the Bottom bracket.

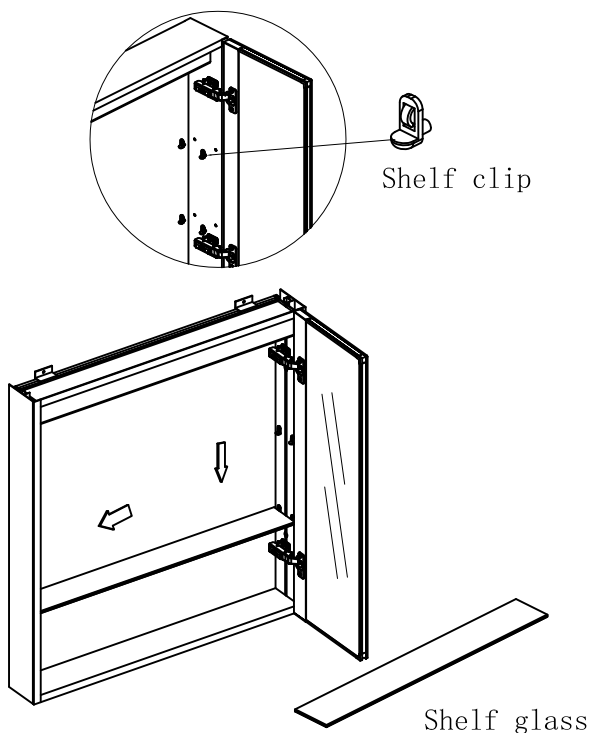

- 3). Install the Shelf clip in the cabinet and put in the Shelf glass.

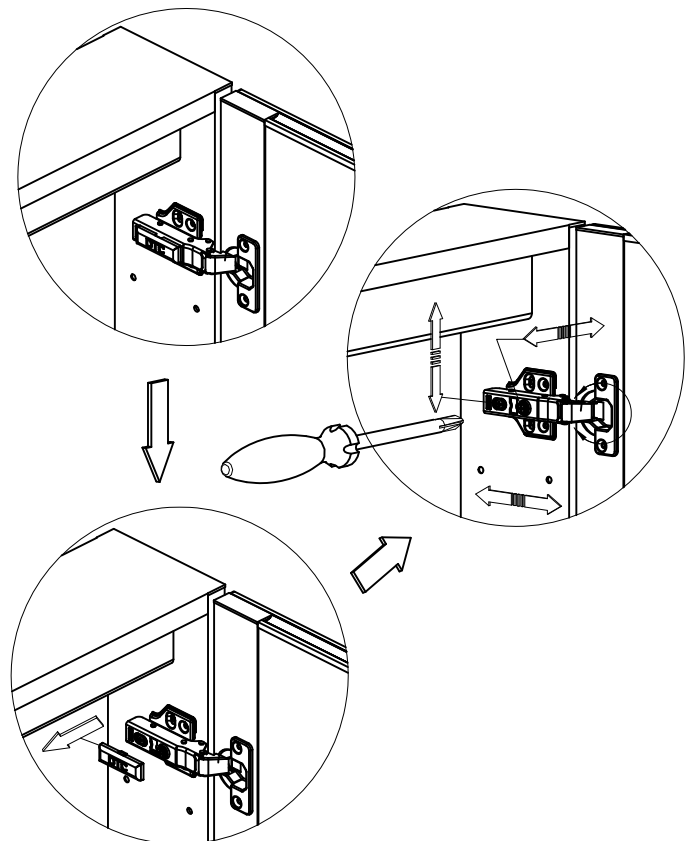

- 4). Adjust door position accordingly.

Parts list			
#	Cabinet Size:	Rough in Size:L*H*W	
LMC. Bay24	24"*31-1/2"*5-1/2" (610*800*122mm)	23-1/2"*30-7/8"*4-1/2" (598*784*108mm)	
LMC. Bay27	27"*31-1/2"*5-1/2" (686*800*122mm)	26-1/2"*30-7/8"*4-1/2" (674*784*108mm)	
LMC. Bay30	30"*31-1/2"*5-1/2" (762*800*122mm)	29-1/2"*30-7/8"*4-1/2" (750*784*108mm)	
LMC. Bay33	33"*31-1/2"*5-1/2" (838*800*122mm)	32-1/2"*30-7/8"*4-1/2" (826*784*108mm)	
LMC. Bay36	36"*31-1/2"*5-1/2" (914*800*122mm)	35-1/2"*30-7/8"*4-1/2" (902*784*108mm)	
LMC. Bay48	48"*31-1/2"*5-1/2" (1219*800*122mm)	47-1/2"*30-7/8"*4-1/2" (1207*784*108mm)	

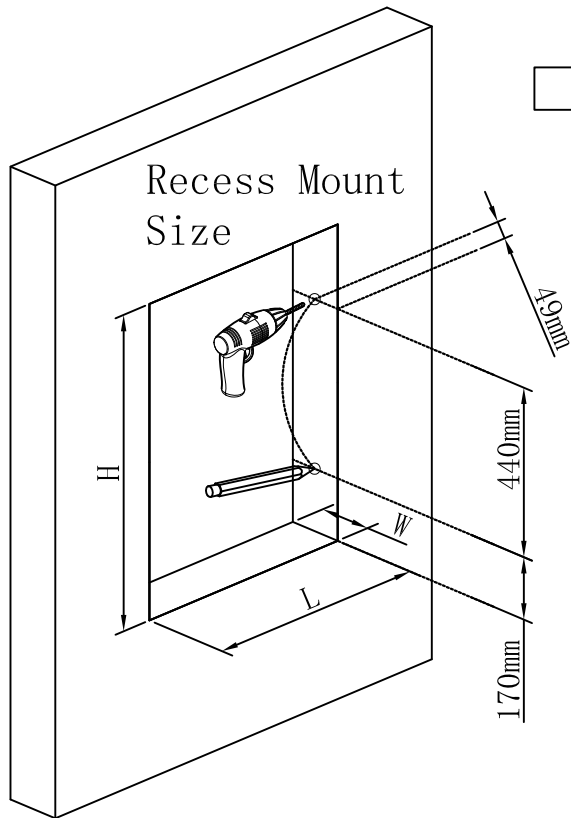

The wall

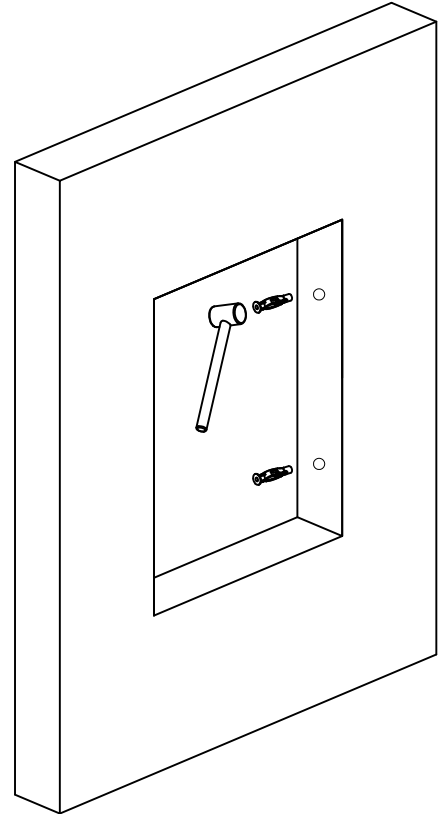

The wall

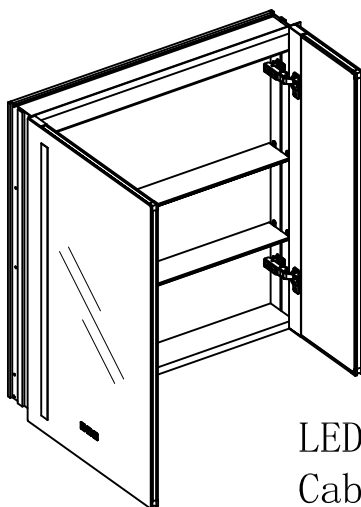

LED Medicine Cabinet

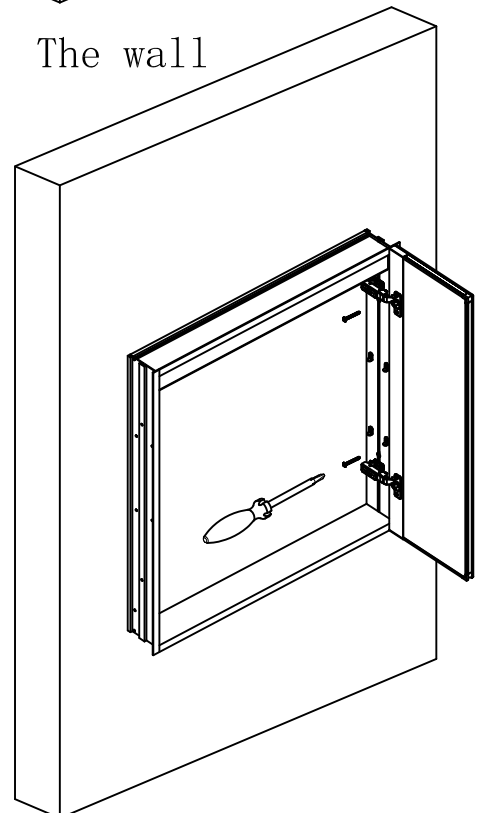

LED Medicine Cabinet Recess Mount.