

Installation for Instruction

ITEM NO:LY8105-22

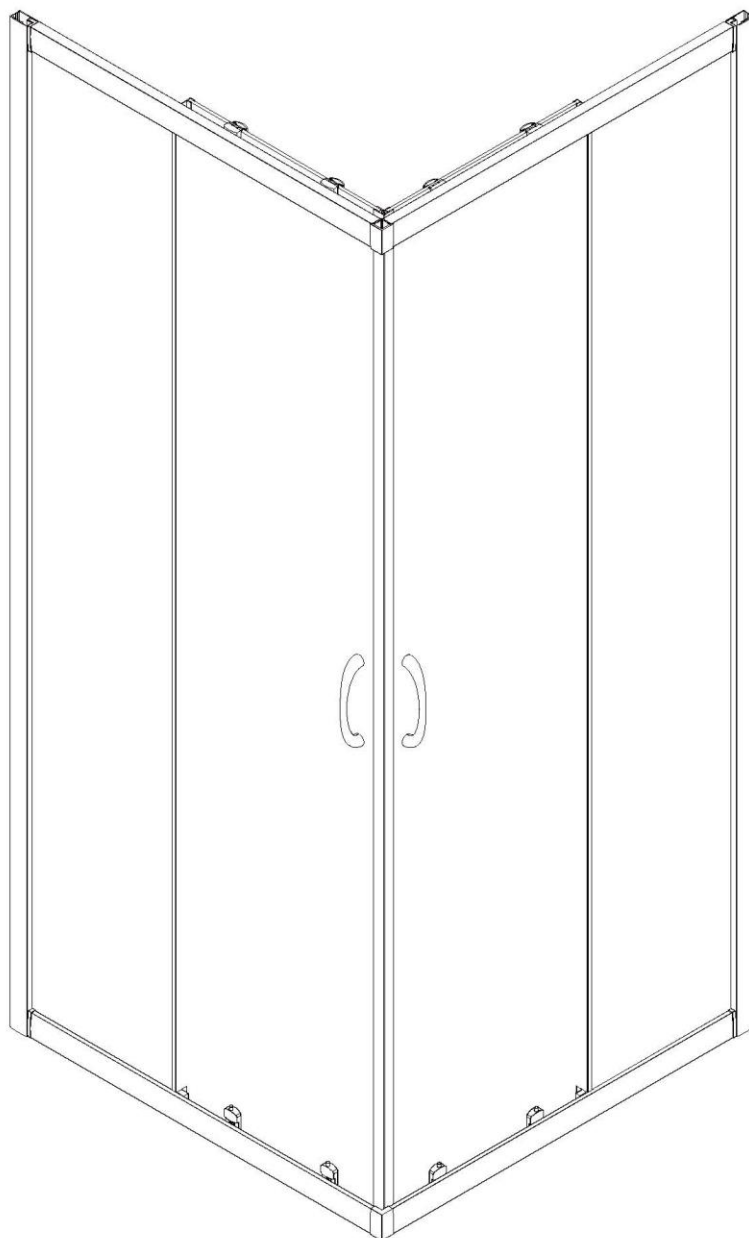

Before you start

Required intallation tools

Not provided

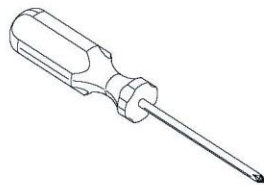

Phillips screwdriver.

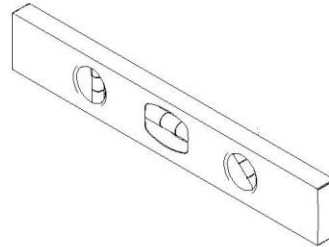

Level.

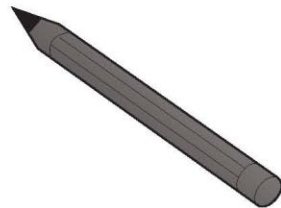

Pencil.



Drill.

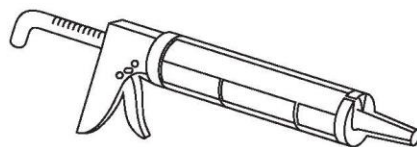

Caulking gun.

Parts list

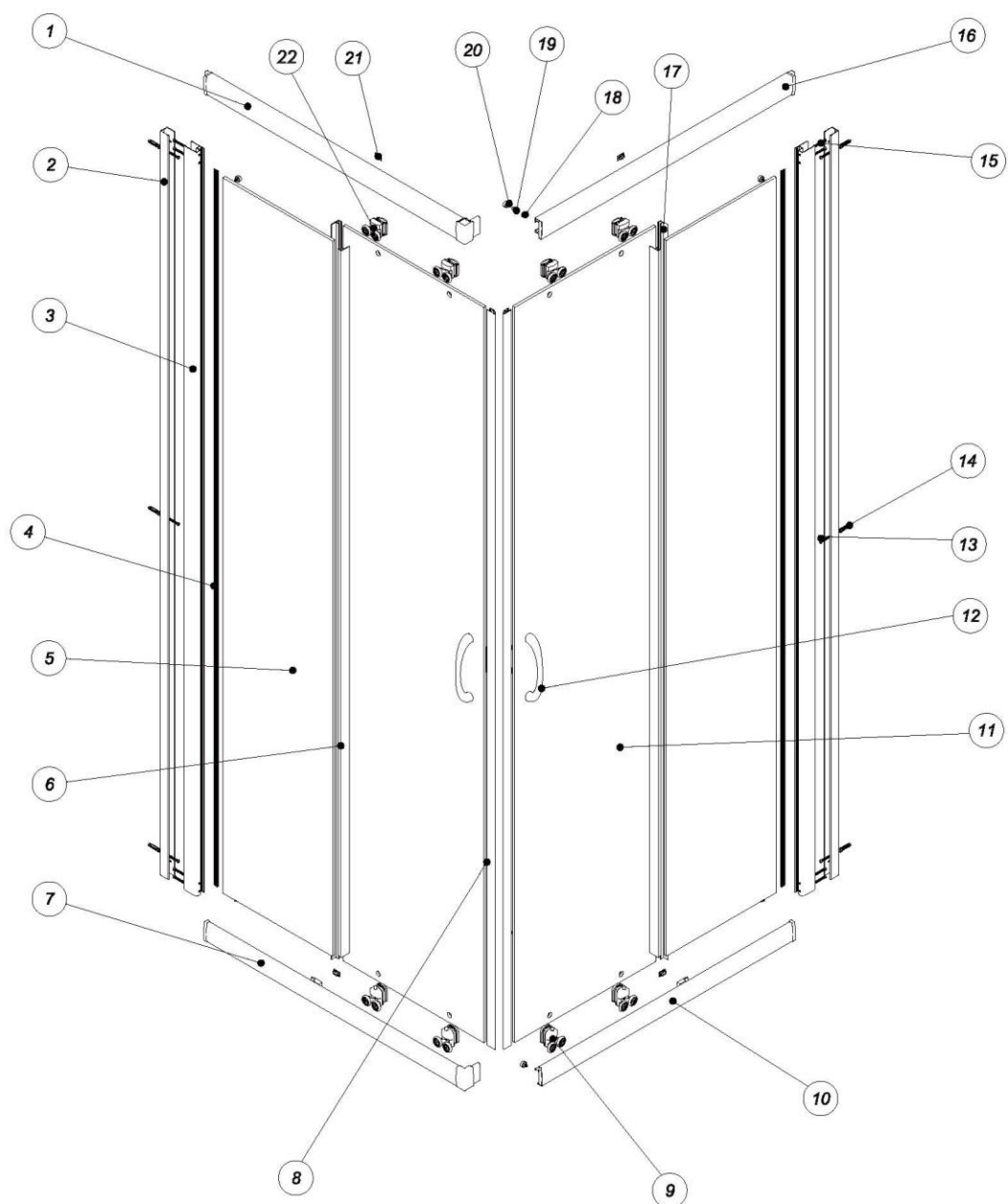

Parts list

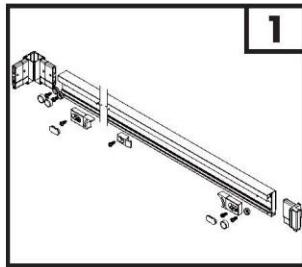

1

Upper left rail set.

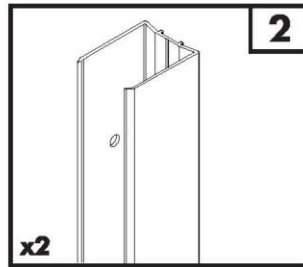

2

x2

Fixation channel.

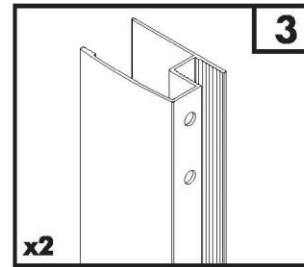

3

x2

Anodized aluminum profile.

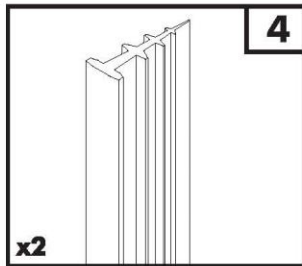

4

x2

Waterproof silicone seal strip.

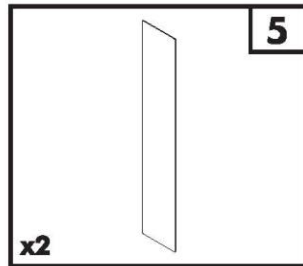

5

x2

Fixing toughened glass.

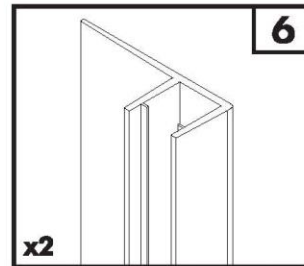

6

x2

Waterproof silicone seal strip.

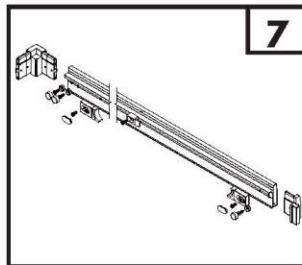

7

Lower left rail set.

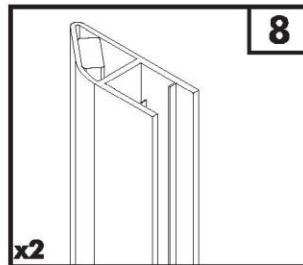

8

x2

Magnetic silicone bar.

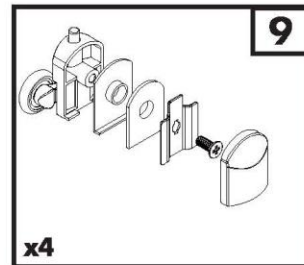

9

x4

Lower-wheel assembly.

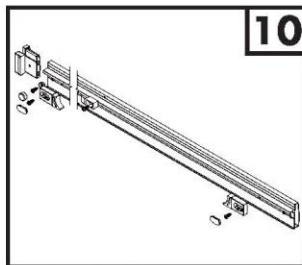

10

Lower right rail set.

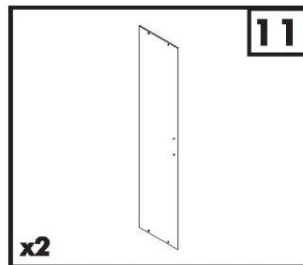

11

x2

Glass door.

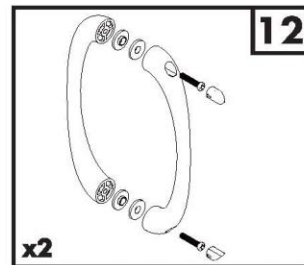

12

x2

Handle set.

Parts list

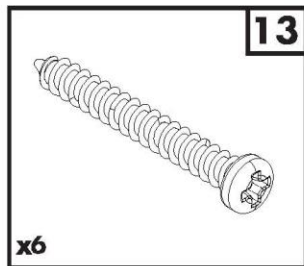

Screw M4x30.

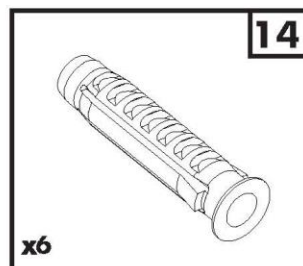

Anchor 6mm.

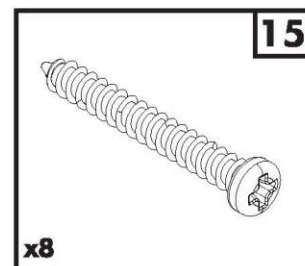

Screw M4x18.

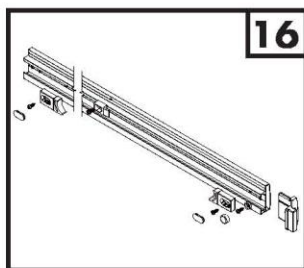

Lower right rail set.

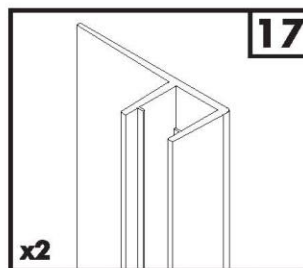

Waterproof silicone seal strip.

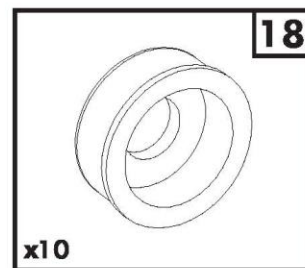

ABS washer.

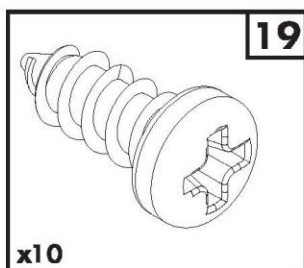

Screw M4x10.

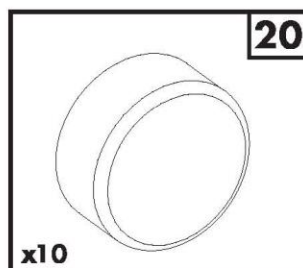

Decorative cover.

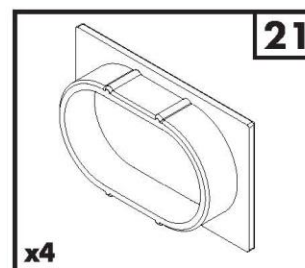

Glass holder cover.

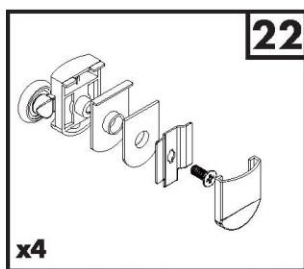

Upper-wheel set.

Door Assembly

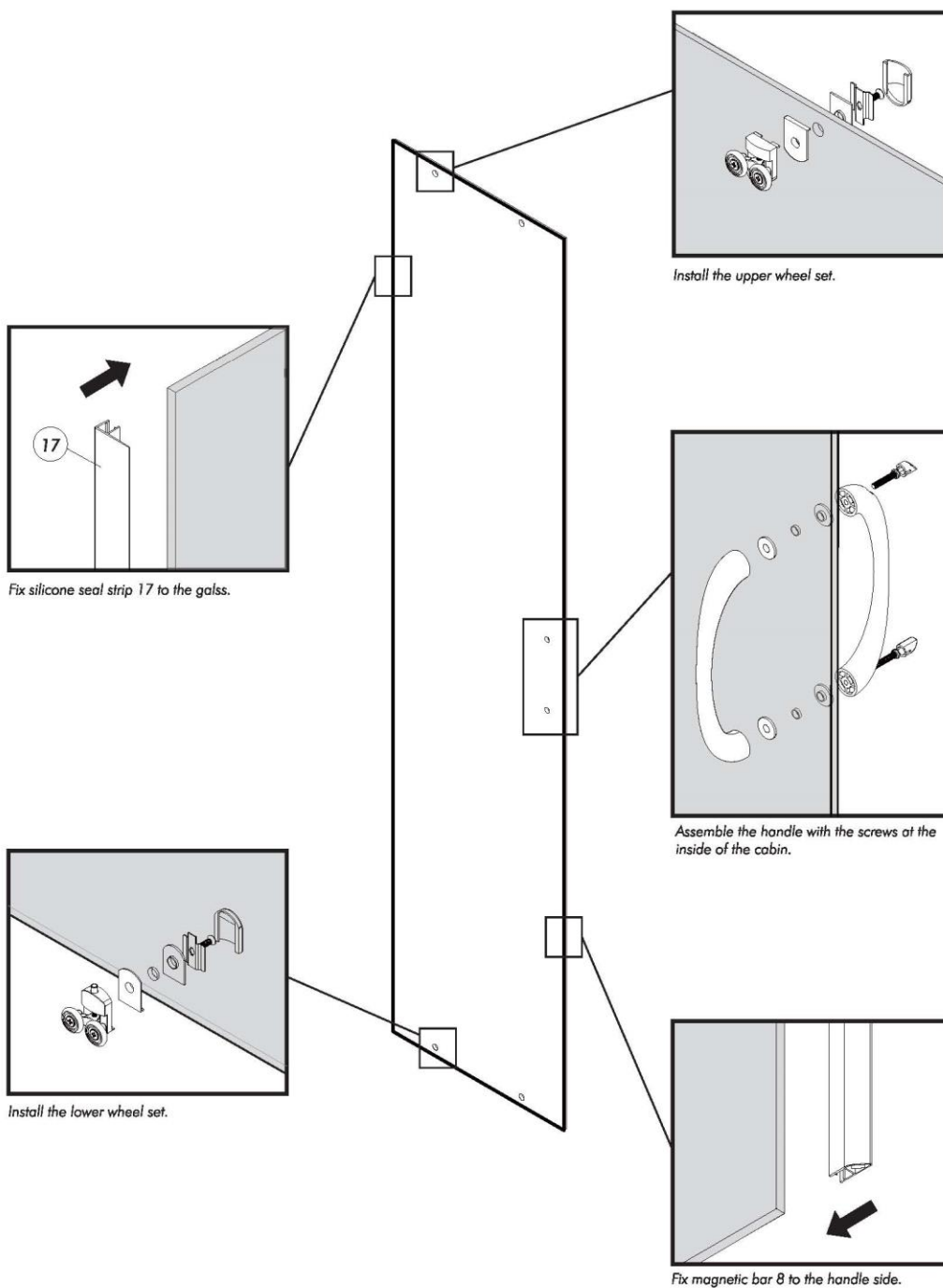

Assembly

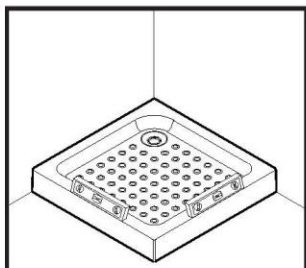

Locate and level the receptacle.
(NOT INCLUDED)

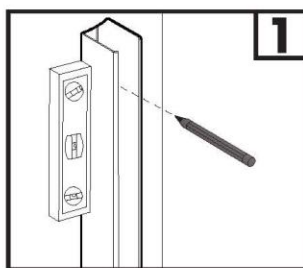

Level the profile 2 and mark the holes for the fixing of the cabin.

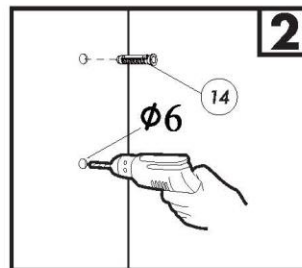

Make the holes and put the anchors.

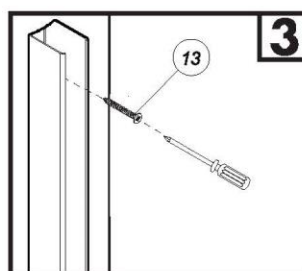
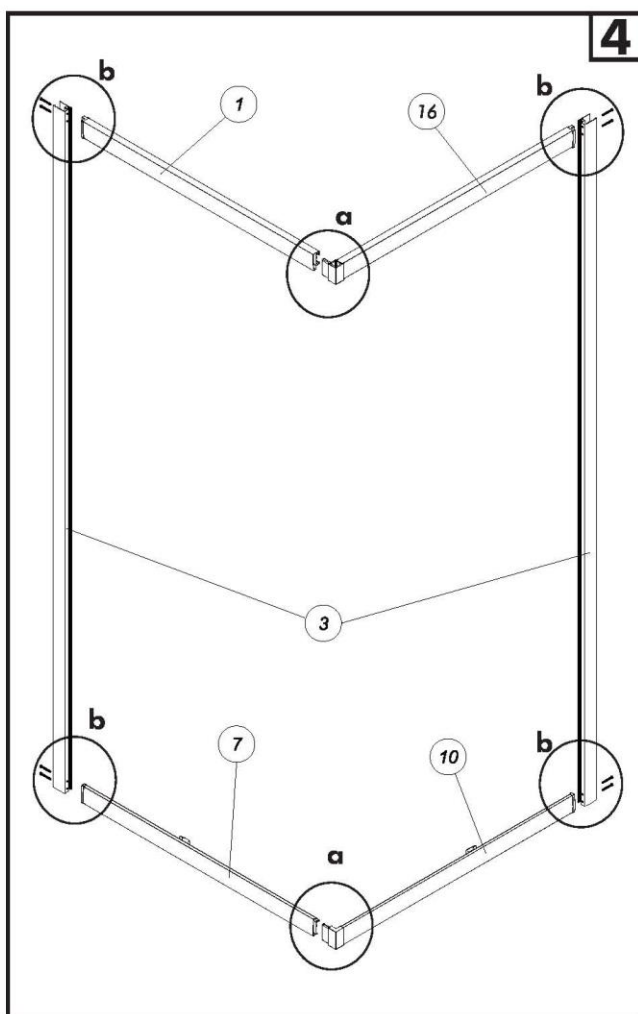

Use M4x30 screw.

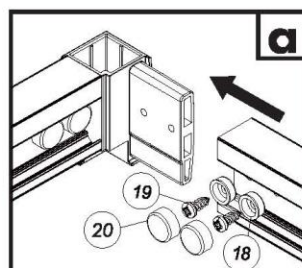

Insert the profile into the corner and fix it with screw.

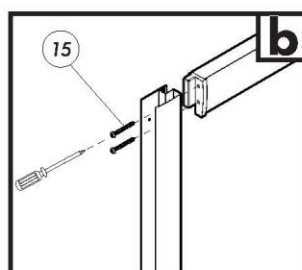

Use M4x18 screw.

Assembly

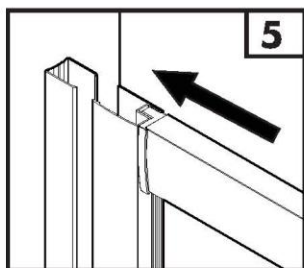

Insert cabin's framework into profile 2 fixed on the wall

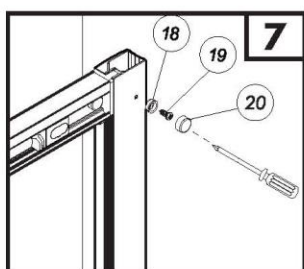

Fix the profiles with the washer 18, screws 19 and decorative cover 20.

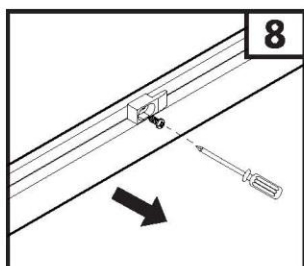

Take off the 4 glass holders.

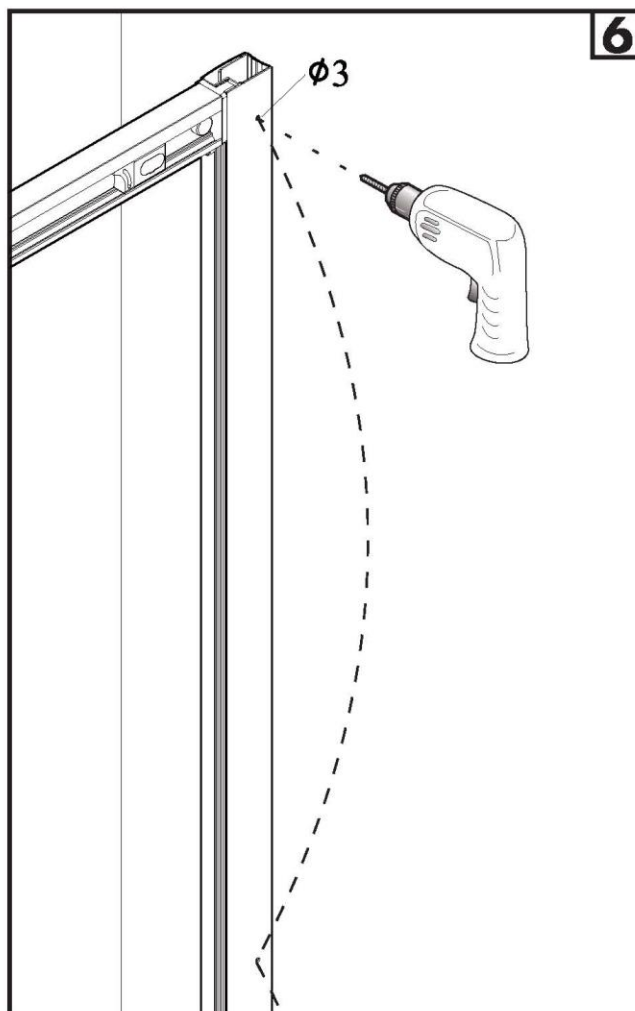

Drill 3 times each profile couple with the electric drill and 3mm drill bit, using the mesaures as reference.

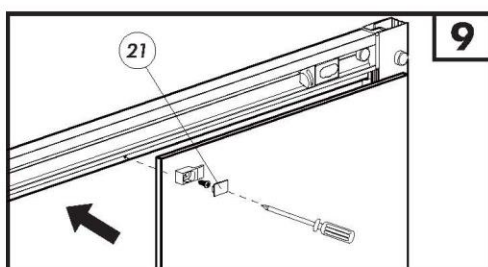

Locate fixing glass on position, fix it with the glass holder and cover 21.

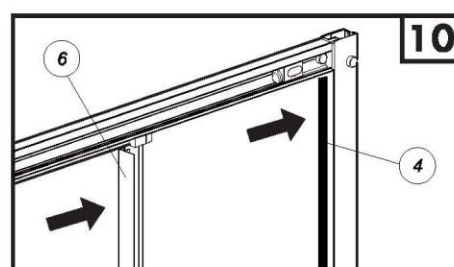

Locate strip seal 4 between fixing glass and profile 3 and the bar 6 on the opposite side.

Assembly

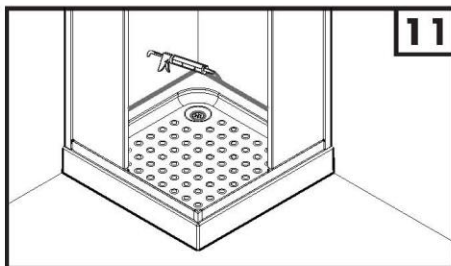

Apply silicone on the receptacle and drain border, filling the gaps within the wall and the receptacle.

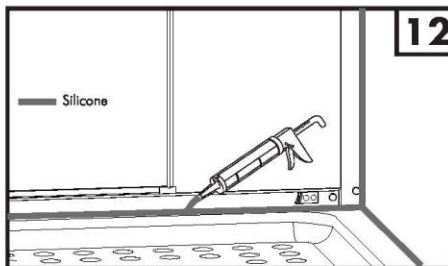

Apply silicone on all borders in contact with the walls and receptacle.

Let to dry and continue with the door's installation.

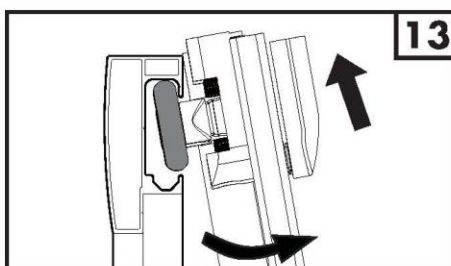

Section view upper rail

Lift and inclinate the glass door as shown in picture of the step 13 and then insert the upper wheels into the upper rail.

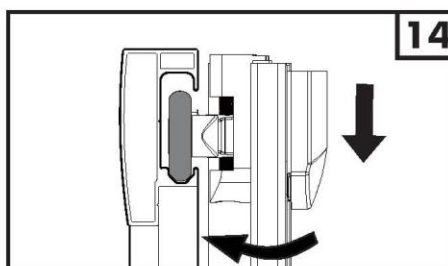

Section view upper rail

Straighten the glass door and get it hangs down slowly. Verify that the all wheel are inside upper rail.

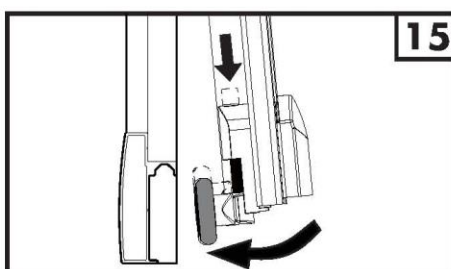

Section view lower rail

Push the button of the lower wheels and locate it into the lower rail.

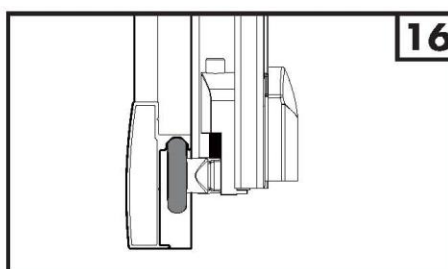

Section view lower rail

Release the button and verify that the 4 wheels are into the rail.