

# Installation for Instruction

ITEM NO:LY8104-22

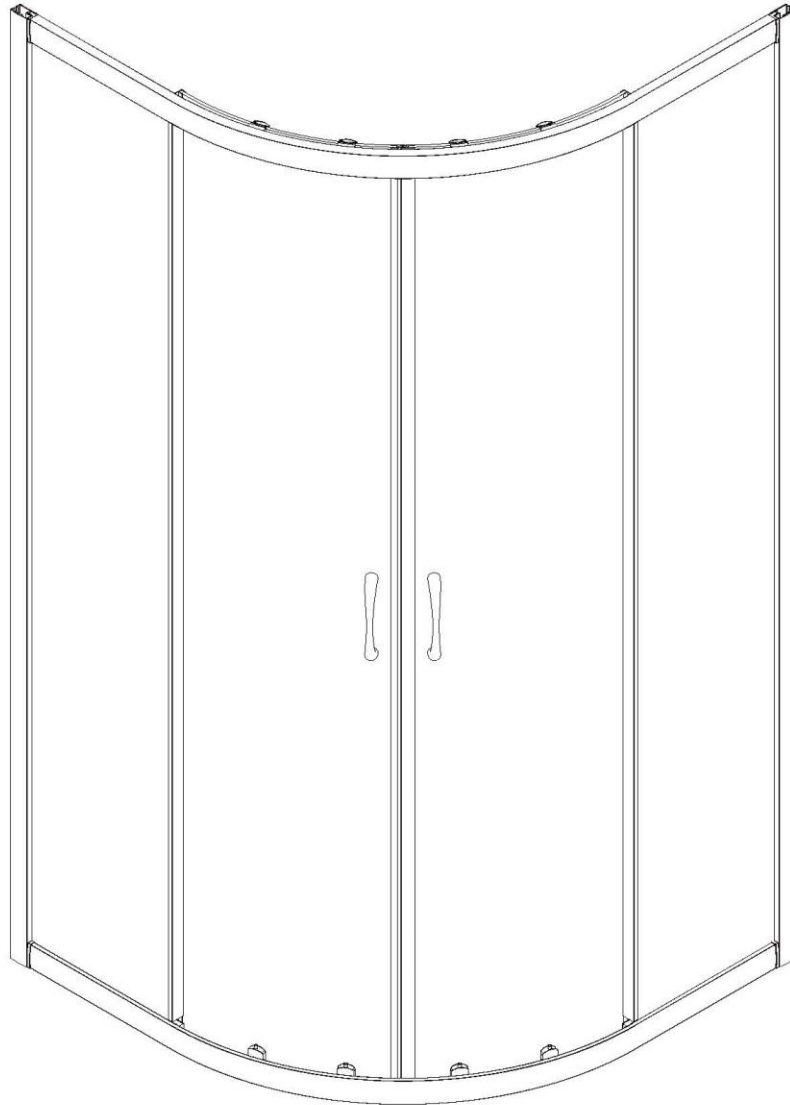

## *Before you start*

---

### *Required intallation tools*

*Not provided*

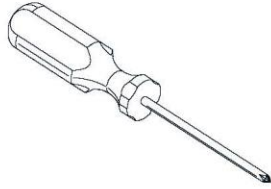

*Phillips screwdriver*

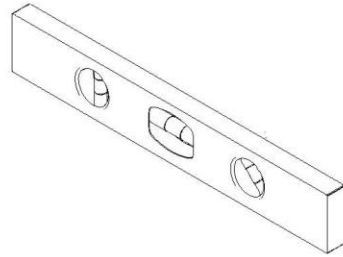

*Level*

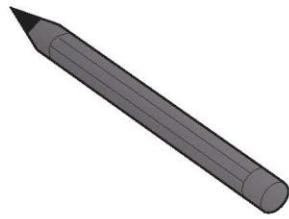

*Pencil*



*Drill*

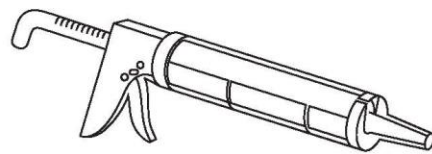

*Caulking gun*

Parts list

---

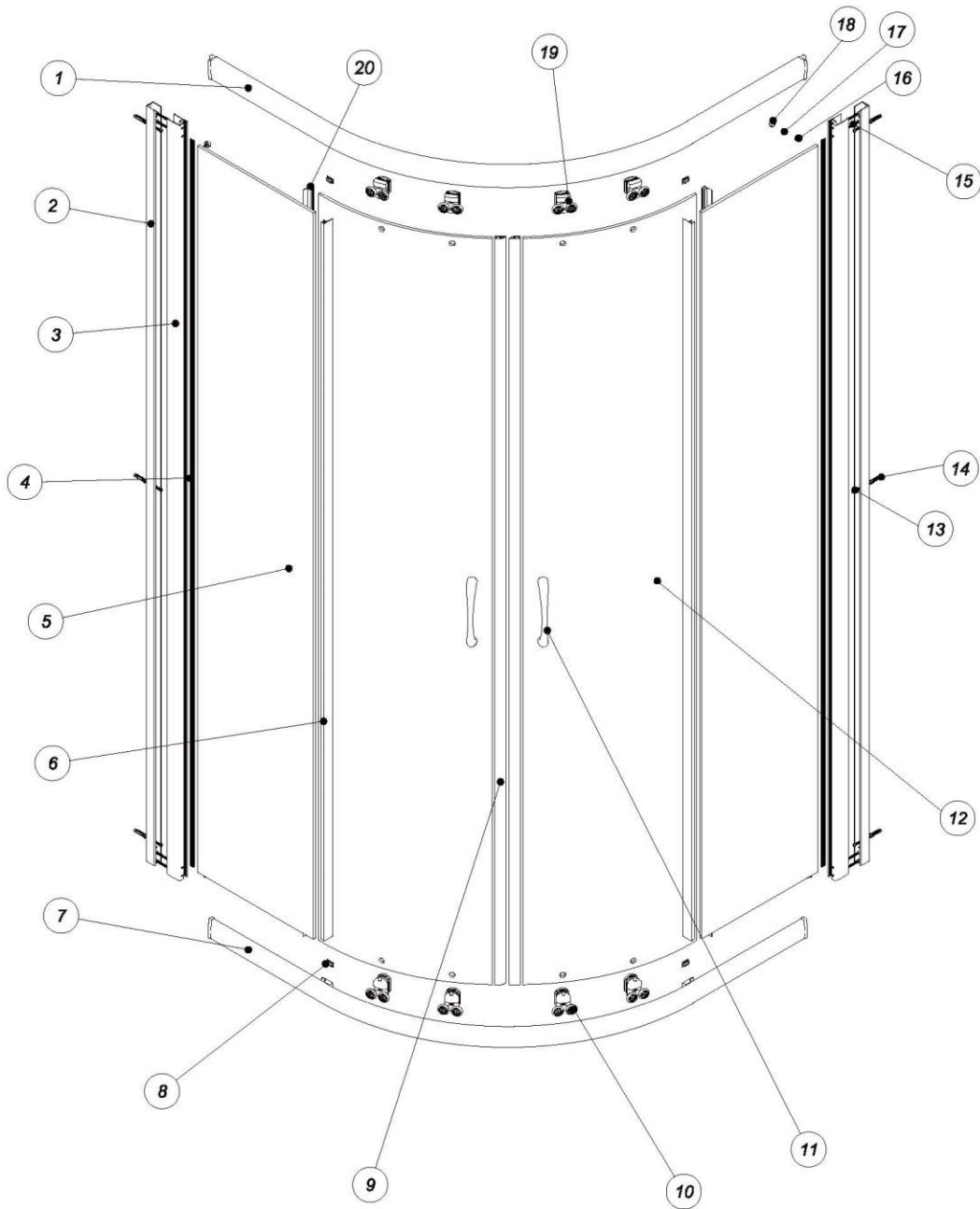

## Parts list

---

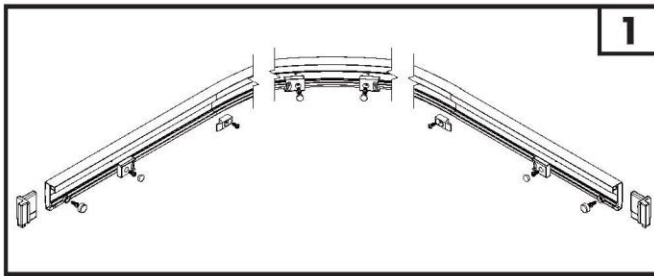

Upper rail set.

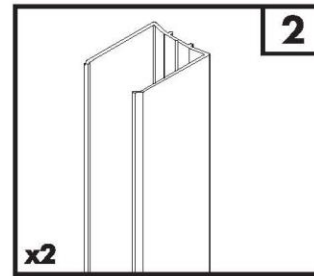

x2

Fixation channel.

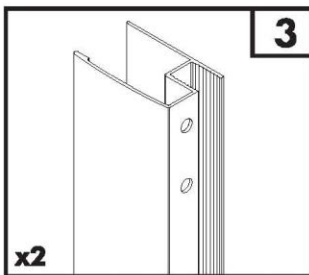

x2

Anodized aluminum profile.

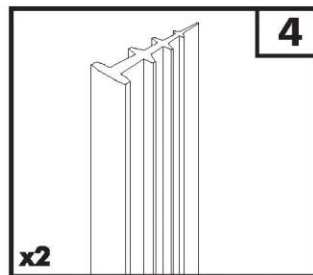

x2

Waterproof silicone seal strip.

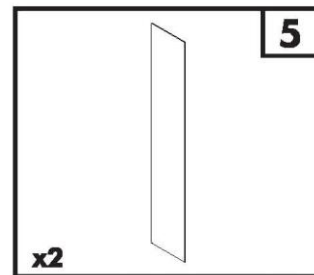

x2

Fixing toughened glass.

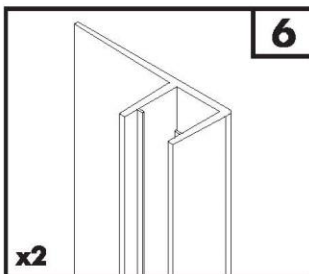

waterproof silicone seal strip

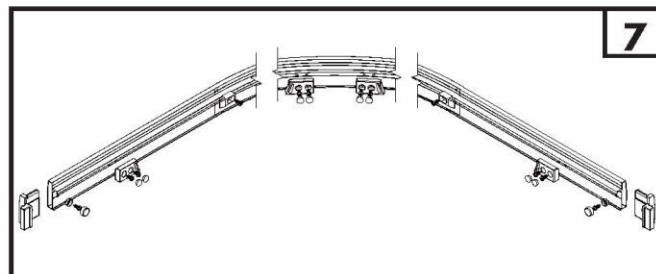

Lower rail set.

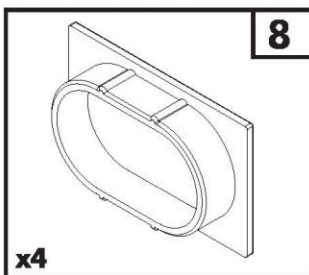

x4

Glass holder cover.

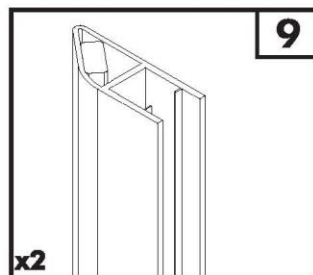

x2

Magnetic silicone bar.

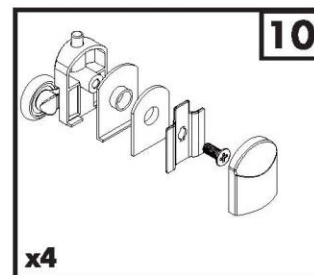

x4

Lower-wheel assembly.

## Parts list

---

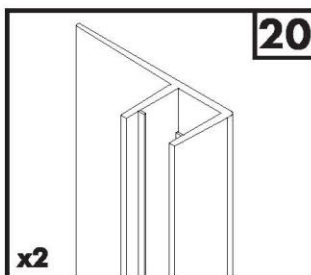
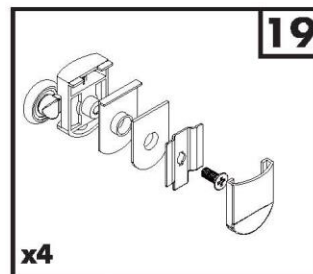
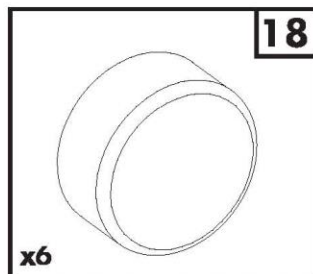
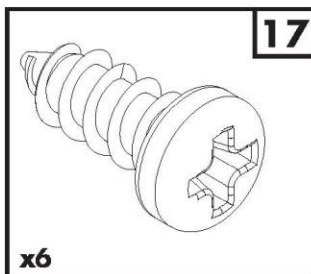
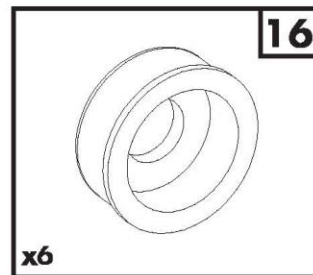
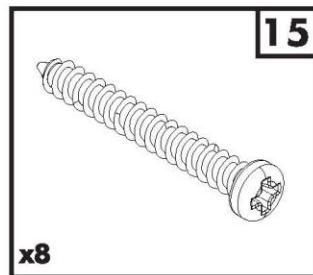
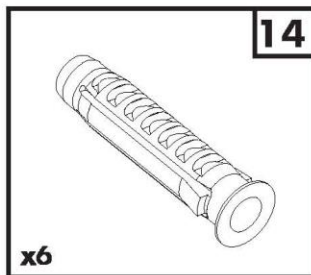
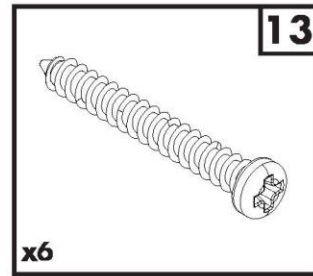
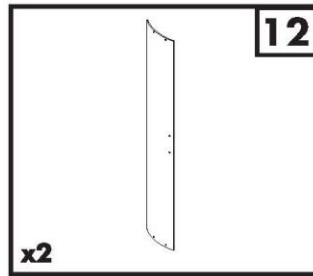
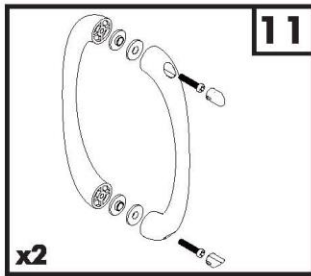

## Door Assembly

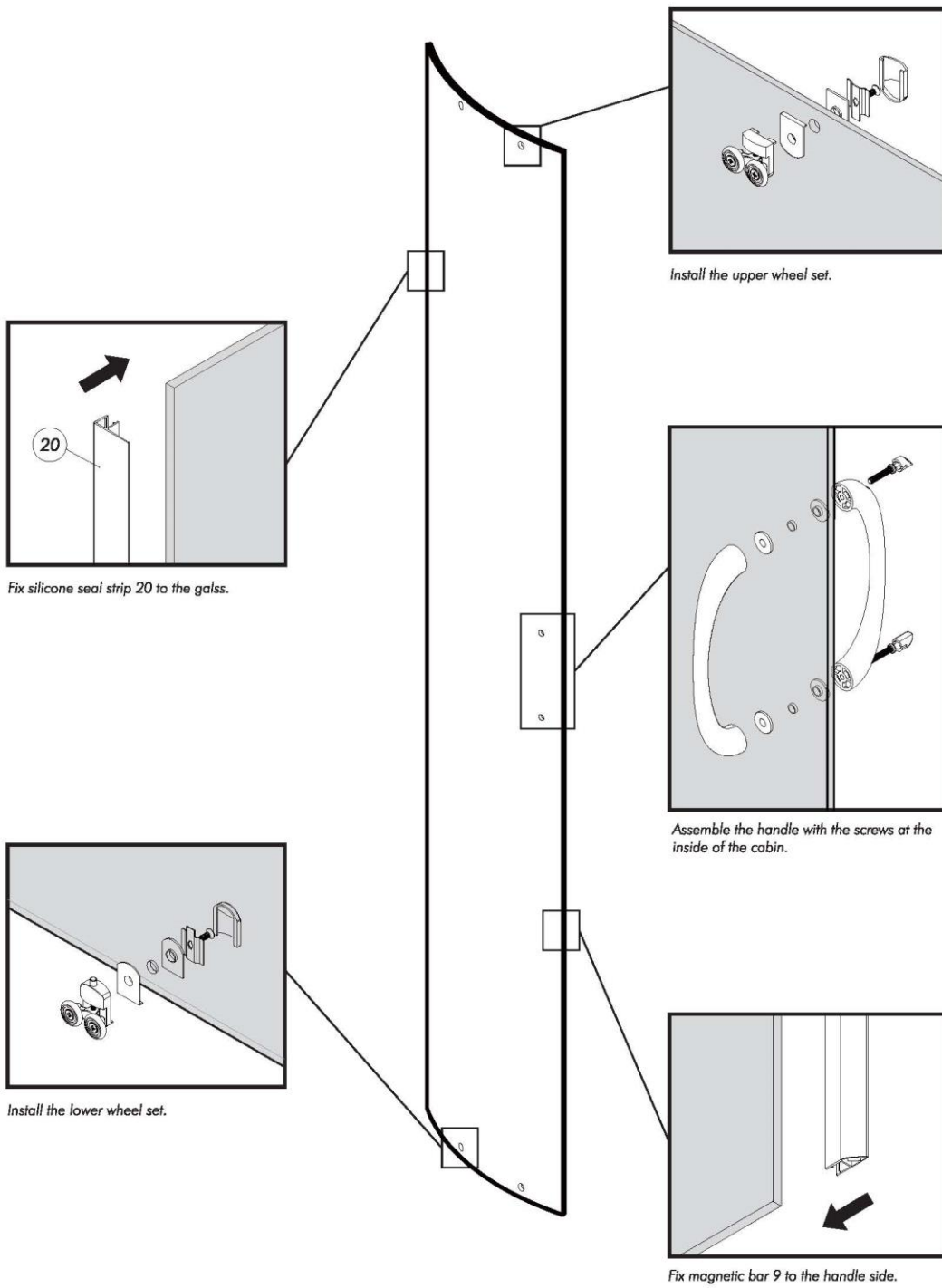

# Assembly

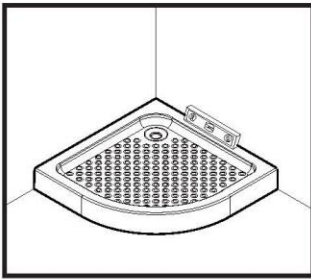

Locate and level the receptacle.

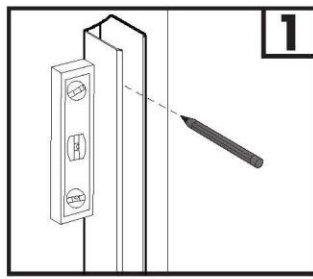

Level the profile 2 and mark the holes for fixing the cabin.

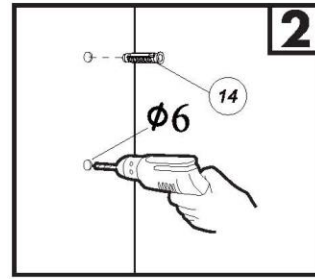

Make the holes and put the anchors.

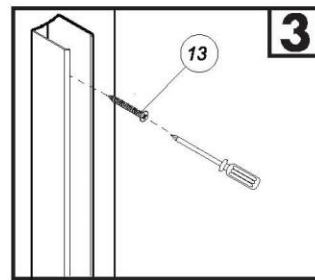
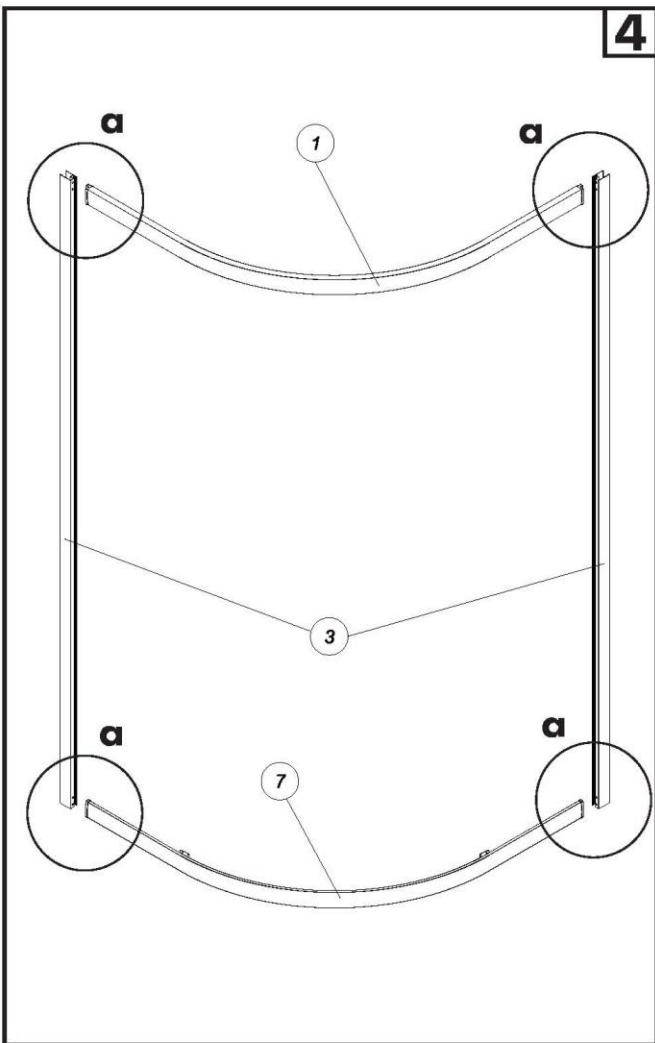

Use screw.

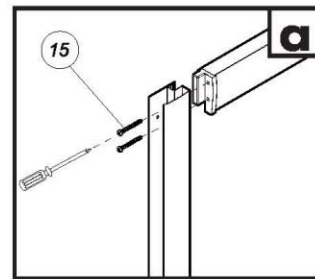

Use screw.

# Assembly

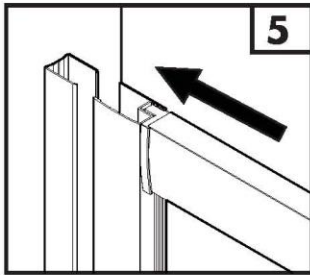

Insert cabin's framework into profile 2 fixed on the wall

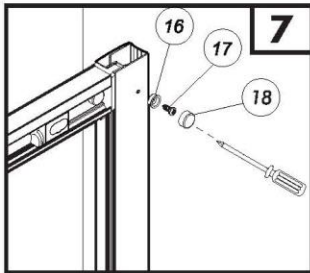

Fix the profiles with the washer 16, screws 17 and decorative cover 18.

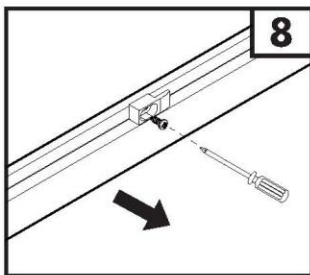

Take off the 4 glass holders.

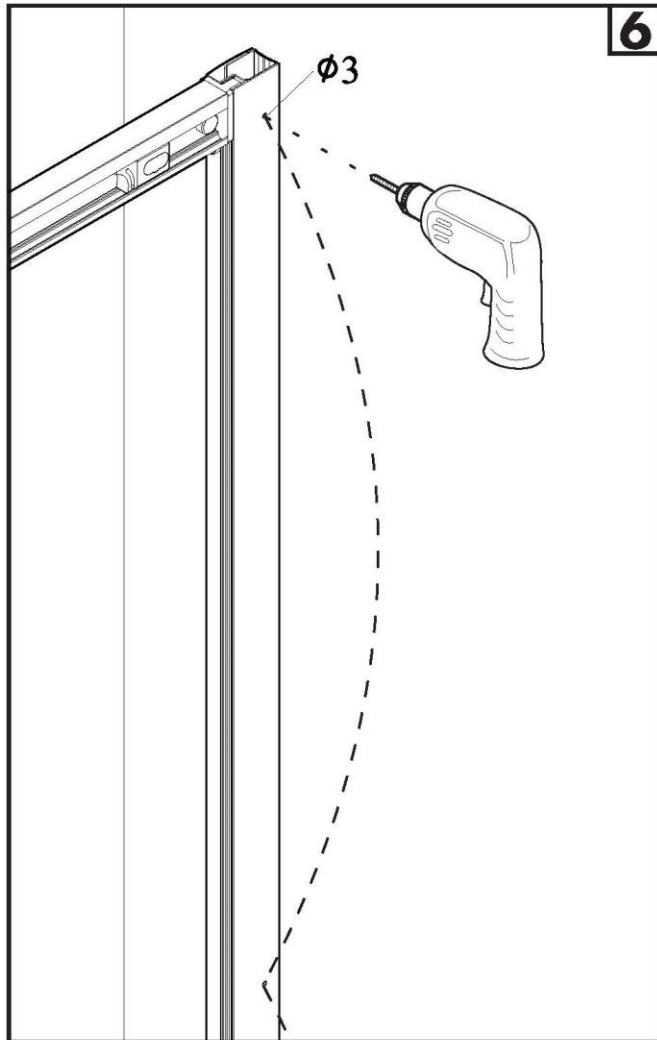

Drill 3 times each profile couple with the electric drill and 3mm drill bit, using the measures as reference.

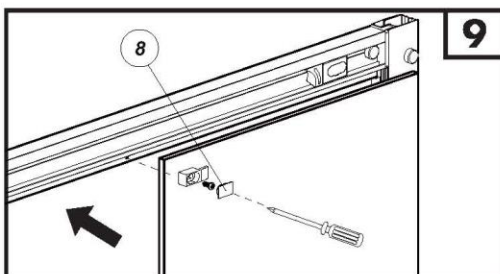

Locate fixing glass on position, fix it with the glass holder and cover 8.

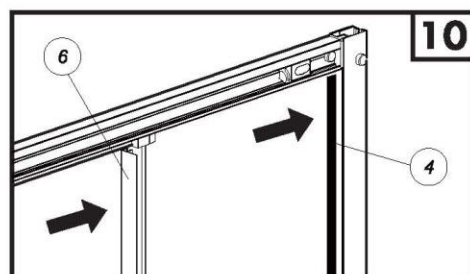

Locate strip seal 4 between fixing glass and profile 3 and the bar 6 on the opposite side.



## Assembly

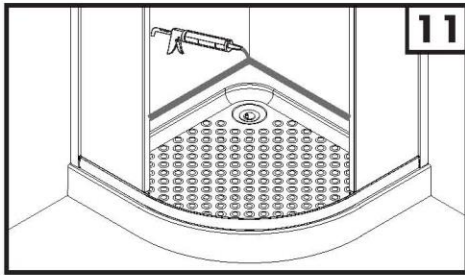

Apply silicone on the receptacle border, filling the gaps within the wall and the receptacle.

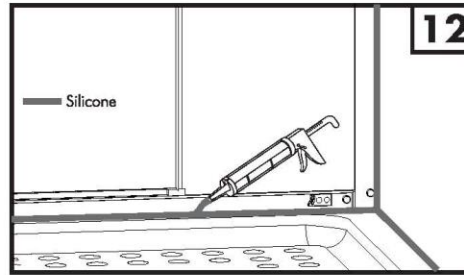

Apply silicone on all borders in contact with the walls and receptacle.

Wait for the silicone dry and continue with the door's installation

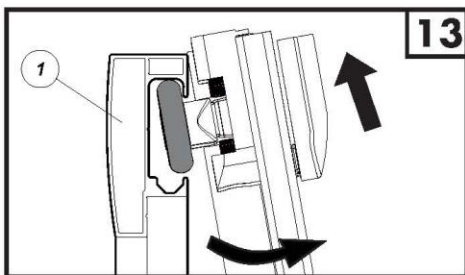

Section view upper rail

Lift and inclinate the glass door as shown in picture of the step 13 and then insert the upper wheels into the upper rail.

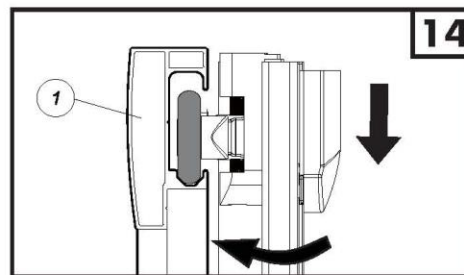

Section view upper rail

Straighten the glass door and get it hangs down slowly. Verify that the all wheel are inside upper rail.

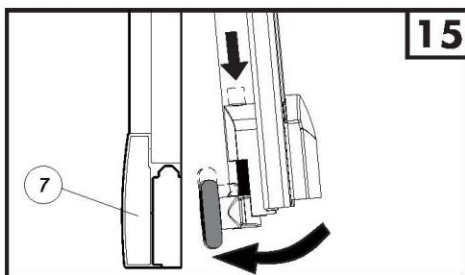

Section view lower rail

Push the button of the lower wheels and locate it into the lower rail.

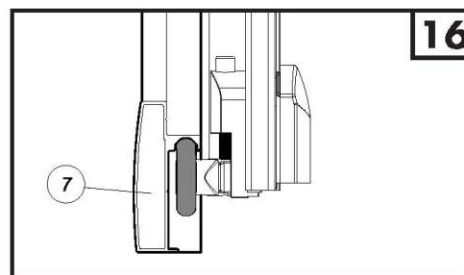

Section view lower rail

Release the button and verify that the 4 wheels are into the rail.