

Installation for Instruction

ITEM NO:LY1206-21

SIZE:38"x38"x75"

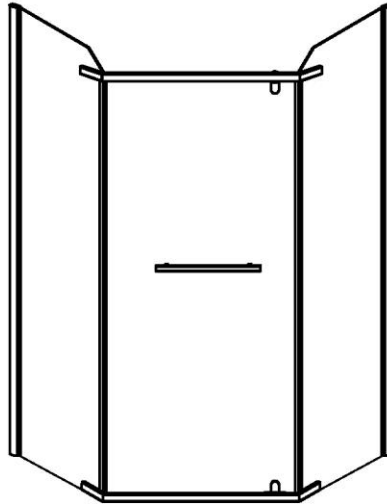

Tools Required



Silicone Sealant



Drill



Level



Rubber Mallet



Pencil



Phillips Screwdriver



Tape Measure



Cutting Pliers



Utility Knife



6mm (1/4") and
3mm (1/8") Drill Bits

** Use the correct type of drill bit for the material being drilled, with 6mm required for anchor fixing and 3mm used for screwing directly into the wall studs.*

Parts List

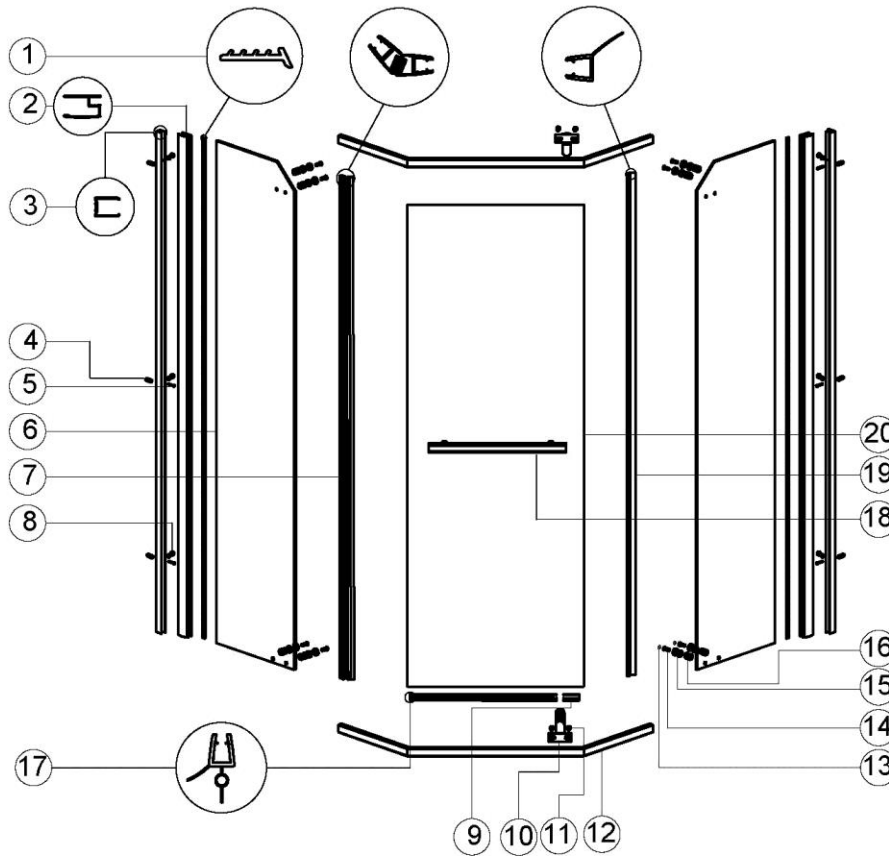

1. Single side rubber	2 pcs	12. Brace	2 pcs
2. Column material	2 pcs	13. Allen Head Screw Cover	10 pcs
3. Wall jamb	2 pcs	14. Countersunk Allen Head Screw	8 pcs
4. Wall Anchor	6 pcs	15. Clamping Washer	8 pcs
5. Phillips Head Screw ST4x30	6 pcs	16. Plastic Washer	24 pcs
6. Side Panel Glass	2 pcs	17. Long Drip Strip	1 pcs
7. Magnetic Door Seal	2 pcs	18. Handle	1 pcs
8. A.B decorative cover	6 pcs	19. Hinge Side Door Seal	1 pcs
9. Short Drip Strip	1 pcs	20. Door Glass	1 pcs
10. Hinge Assembly	2 pcs		
11. Allen Head Screw M8x15	4 pcs		

1

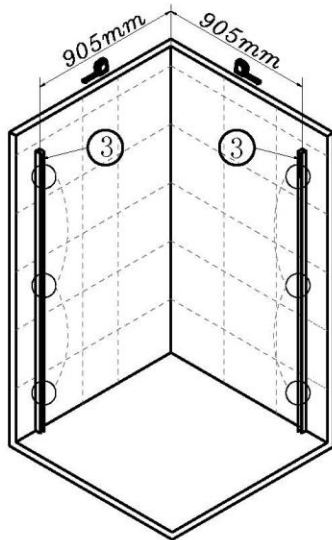

Install the Wall jamb.

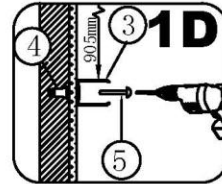
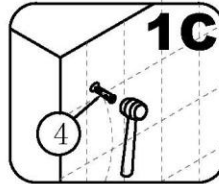
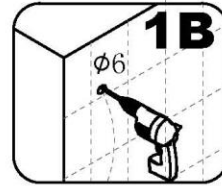
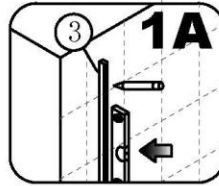

2

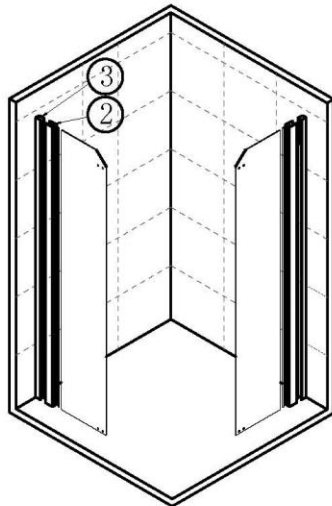

Install the Side Panel Glass.

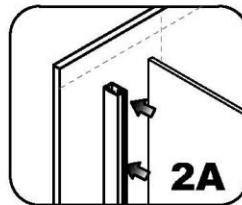

Important: Seal must be fully inserted.

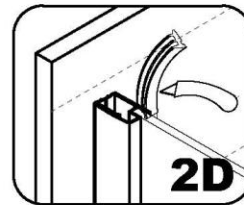
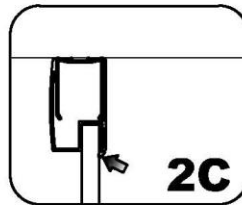

3

Fit metal brace to the top and bottom.

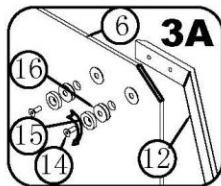
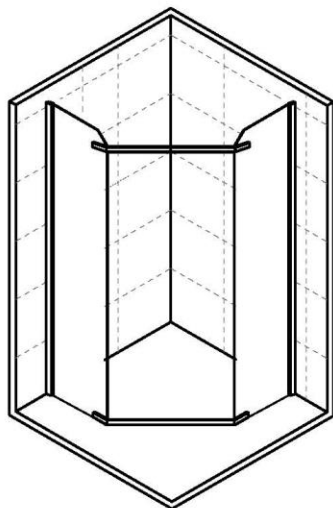

Install the top hinge to the door.

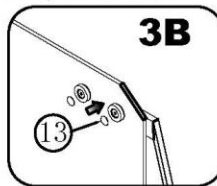

Install the bottom door hinge on the brace.

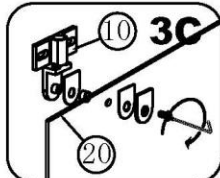

Install the door onto the bottom hinge.

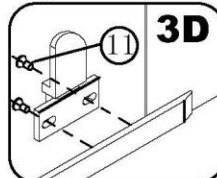

Attach the top hinge to the top brace.

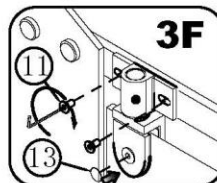
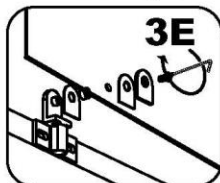

4

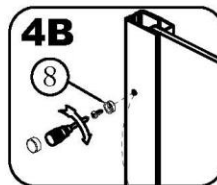
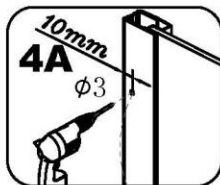
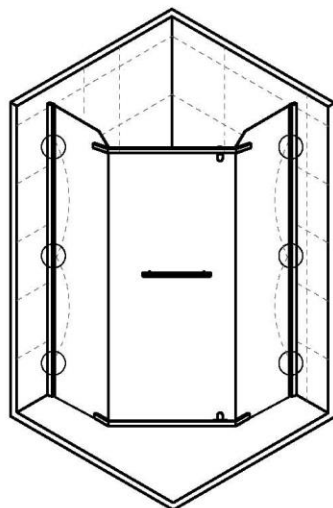

Install the Handle.

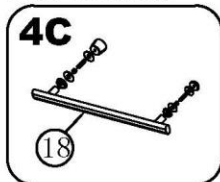

5

Note steps 5B to 5D show the seals being installed on the door with the frame removed for clarity.

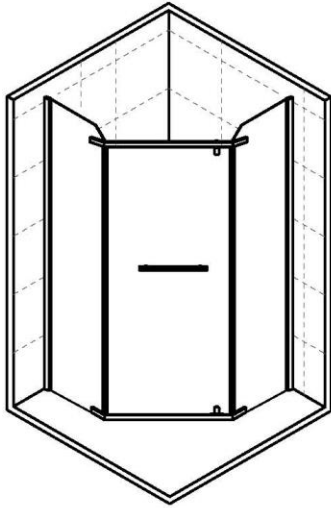

Cut the seals to the correct length before fitting.

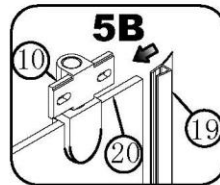
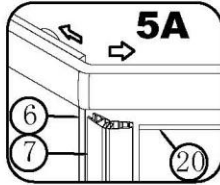

Install the vertical door seals along the whole height of the door, and fit the bottom drip strips in between.

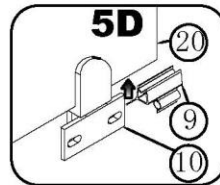
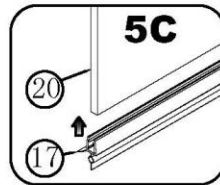

6

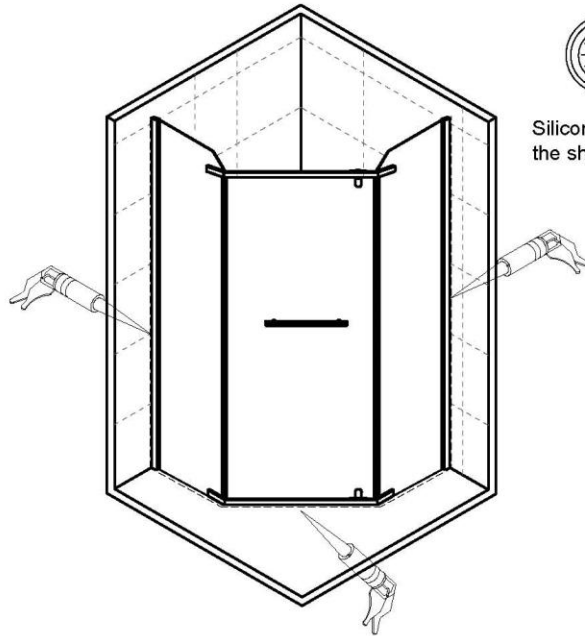

Silicone inside and outside of the shower.